

THE GHOST BUST[®] SETUP INSTRUCTIONS

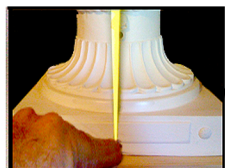

String should have equal length at center, left corner and right corner of the bust.

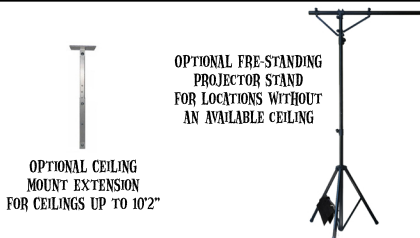
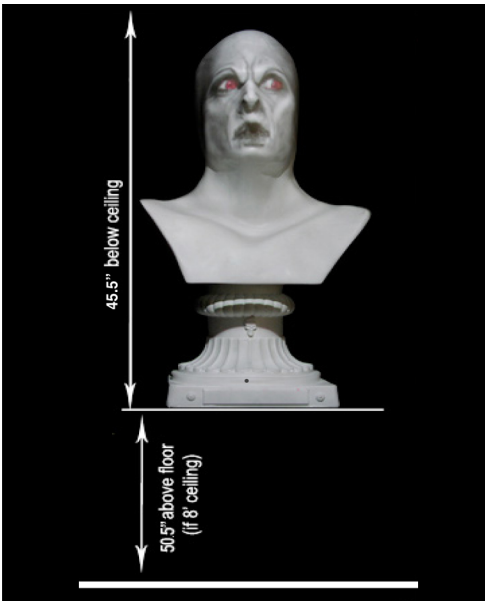
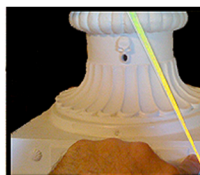

POSITIONING

The positioning of the projector and bust is important for getting a good effect with the Ghost Bust. To begin, place the Ghost Bust in the spot you've chosen for it. If you'll be mounting the projector to a standard 8' ceiling, the bust should be placed on a surface that is 50.5" above the floor.

If mounting to a ceiling that's higher or lower, add or subtract the same additional inches to the height of the surface the bust will rest on. Alternatively, you can purchase an extension for the ceiling mount for higher ceilings up to 10'2". If no ceiling is available, we have free-standing projector stands available. Contact us at info@nightfrights.com to order.

TIP: Night Frights offers an adjustable riser for quick setups. Visit our online store at www.nightfrights.com.

Once the bust is in its general spot, it's time to find the proper location for the projector. The projector needs to be mounted to the ceiling at a distance of 6' from the bust, measured diagonally from the center of the name plate on the bust to the projector lens.

TIP: Attach the projector mount to the projector and tape a piece of string onto the center of the projector's lens cap. Measure and mark the point on the string that's 71" from the lens, (6 feet minus 1 inch, which is the distance from the cap to the lens). Have someone hold the mark you just made on the string firmly against the center of the bust's nameplate while you position the projector and its mount up against the ceiling, moving it away from the bust until the string is fully extended. That's the spot to mount the projector! Mark the location of the screw holes in the ceiling plate and attach it according to the instructions that came with the mount.

Fine-tuning the position is next... Look to see that the bust is right in front of the projector lens, and not off to one side. Use the same string you used previously and touch it to the top left corner of the Ghost Bust's base. Now touch the same spot on the string to the top right corner of the base. Rotate the bust until both corners are the same distance away from the projector.

This ensures the bust is turned at the right angle to face the projector properly.

GHOST BUST SETUP INSTRUCTIONS (CONTINUED)

VIDEO PLAYER CONNECTIONS

Plug the black end of the provided AV cable into the yellow AV jack on the back of the Sprite and attach the cable's red and white RCA plugs to your sound system. (The yellow plug is not used.) Do not try to use the tiny speaker in the projector. Always use a powered speaker for the audio.



Insert the thumb drive into the Sprite's USB slot and connect the Sprite's power cable. The blue LED should illuminate.

PLAYING THE VIDEO

When the Sprite starts up, it will loop the first of two videos continuously, giving the bust the appearance of a motionless greek statue. Once the Sprite is triggered by an attached pressure mat, PIR sensor, or hand-held switch, (sold separately), the Sprite will play the Ghost Bust video.



If you would like to feature a different routine at any time, simply copy the new file to the thumb drive. The video whose name starts with "001" (and comes first alphabetically if there are more than one) will be the file that gets triggered.

If your mat or PIR has a 1/8" plug on the end of its cable, plug it into the Sprite's I/O jack. If your trigger has two wires instead of a plug, connect them to the screw terminals marked "R" and "⊥", (for "ground") on the small black and green plug adapter included in the Sprite box, and insert the adapter into the Sprite's I/O jack.

SETTINGS

The Sprite's settings have already been set for you, but if the settings accidentally get changed, point the Sprite's remote at the Sprite's front panel and make sure the following settings are correctly set.

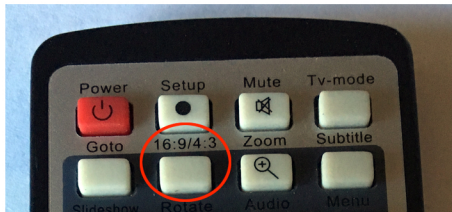

Press the button labeled "16:9/4:3" on the Sprite's remote and cycle through the options until you see the numbers 16:9 displayed on the projected image. 16:9 is the proper setting on the Sprite even though the projector is set to 4:3.



If you're not getting any audio into your sound system, press the Setup button (next to the red Power button). Use the remote's orange arrow keys to scroll down to "Audio Output Mode", then press the green "Enter" button. Scroll down to the A/V option and press Enter again.

For switch mats and hand-held switches, Control Mode should be set to "Trigger Low". For PIRs: "Trigger High". Press the yellow "Return button twice to exit.

GHOST BUST® SETUP INSTRUCTIONS (CONTINUED)



PROJECTOR SETTINGS

Attach one end of the included HDMI cable to the HDMI input on the projector; the other to the Sprite's HDMI output jack.

Turn on the projector via the remote control or by pushing the Power button on top of the projector. The image will slowly brighten over the next 30 seconds until you can see an upside-down character being projected. We'll need to flip the image. It may be easier to see the projector options if you prop a piece of cardboard in front of the bust to project onto.

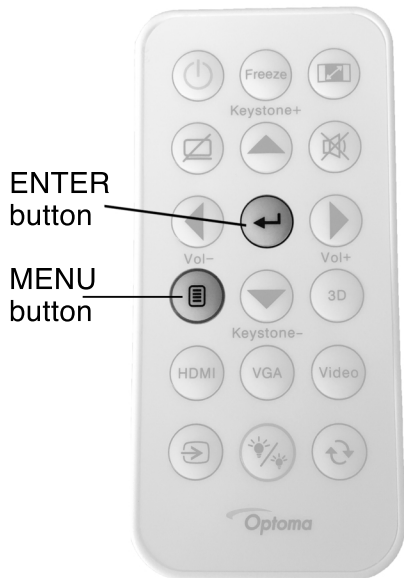

Press the MENU icon on the projector's remote, then use the DOWN ARROW KEY twice to select the gear icon. Press the ENTER button. Press the ENTER button again to select the Projection options. Press the UP ARROW KEY once and press ENTER. You should now see everything right side up and read-able, though the character will appear to be too small. Let's fix that.



Press the ASPECT RATIO button, (the top right button on the remote), and use the left and right arrow keys to scroll through the options until you see the 4:3 option. Press the ENTER button.



Next, let's turn the Economy Mode on to double the lamp's life. Press the BRIGHTNESS MODE button and use the arrow keys to set the Brightness Mode to "ECO" (Economy Mode).

NOTE: To adjust to your room's brightness levels, you can choose a brighter or dimmer preset mode by pressing the MENU button and then ENTER three times until you get to the screen where you can audition the different video modes. Pick whichever looks best to you in your environment.

GHOST BUST® SETUP INSTRUCTIONS (CONTINUED)

Aim the projected image at the bust and focus the projector. Make sure the Zoom lever is set all the way to the side that makes the image the smallest.

Use a level to check to see that the bust's base is level. Next, rest the level on top of the back end of the projector and get the projector as level as possible too. Always keeping the necessary 6' between the projector and bust, adjust the projector and the bust to get the face looking good and the projected light contained within the bust's borders.

A setup screen is available if you'd like to see some additional markers to help align the bust even more accurately. To access it, press the blue "File" button on the Sprite's remote, then the green "Enter" button four times to make your way to the Setup.mp4 file. Make sure the green rectangle projected on the base of the bust fits nicely within the nameplate area and is level. If the face isn't aligned, you can re-aim the projector later, for now, the green rectangle will help with leveling the projector and getting the proper distance. Once the green rectangle fills the nameplate properly, nudge the projector's aim to align the face properly.

Pay special attention to the nostrils. Get them in the right spot on the bust and you should be in good shape.

When you're done using the setup screen, (if applicable), slide the SD card out and back in to return to the main video

Once you're set, dim the lights, turn up your sound system, hit play, and enjoy the show!

Storage: Be sure not to subject your bust to high temperatures! Avoid storing it in hot attics or other hot spots where excessive heat can deform its shape!



Leveling the bust

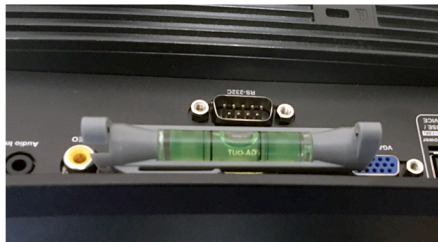

Leveling the projector



Checking nostril position



RECOMMENDED ACCESSORIES FOR YOUR GHOST BUST®



PIR Sensor
(2" x 2")
\$49



Hand-Trigger Switch
(For manual operation)
\$49



Pro Quality Switch Mat
(18 x 24")
\$59



80 Watt Wall-Mount Speaker
\$199



Video Key Pad
Triggers Multiple Videos
\$249

GHOST BUST LIVE™



Interactive Software
\$99



Adjustable Risers
\$199

AVAILABLE AT WWW.NIGHTFRIGHTS.COM

YOU MIGHT ALSO LIKE

